

Instructions for Use

Stopcock with Swabable Valve

Single Use Only. Do not reprocess or reuse.

Not made with natural rubber latex.

The Robertsite® valve is used in several different medical devices.

The technique for accessing the valve is the same.

Cat. No. : 245884024B

Cautions:

- To prevent valve damage, **DO NOT USE** needles or blunt cannula to access the swabable valve.
- Carefully follow the directions below to maintain the valve integrity.
- Only use standard Luer connection devices; non-standard syringes or connectors can damage the swabable valve. A standard luer connection must conform to the harmonized standards ISO 80369-7, ISO 594-1 and/or ISO 594-2. Syringes and male luer connectors have a large variety of configurations and can vary significantly in design and dimensions.
- DO NOT OVER-TIGHTEN** connections. **DO NOT USE** any instruments to tighten connections.

INSTRUCTIONS FOR USE:

Fluid Management in 4-Way Stopcock

- Prime the stopcock before use. Approximate priming volume is 0.45ml. Ensure that all air bubbles are removed.
- The molded arrows on the stopcock handles indicate the open flow paths in relation to the 3 ports. Turning the stopcock handle to the intermediate position, as shown in Illustration 1, can close all fluid paths.
- Attach IV fluid device(s). Follow the specific Robertsite® instructions below. Ensure that all connections are secure.
- ROTATE THE HANDLE TO THE SELECTED FLOW PATH SETTINGS.** See illustrations 2 through 5, for 4-way flow options.

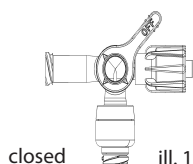

closed ill. 1

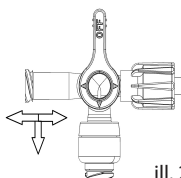

ill. 2

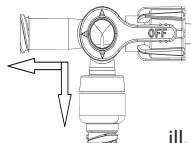

ill. 3

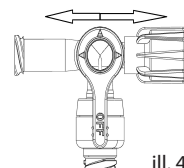

ill. 4

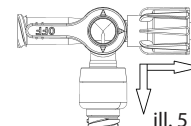

ill. 5

Accessing the Robertsite® Swabable Valve

- Using aseptic technique, remove the sterile device from the package. Discard if packaging is not intact.
- Using a sterile alcohol wipe, swab the surface of the valve (*illustration 6*). Let it air dry.
- Carefully connect the syringe or extension set to the valve by pushing the syringe or other Luer connection **straight** into the swabable valve using a clockwise, twisting motion. **DO NOT** try to insert at an angle or try to pry open the slit in the valve.
Note: When using rotating collar MLL connectors ensure that collar is rotated and connection is secure.
(See illustrations 7 (a and b) and 8 (a and b) for proper accessing techniques.)

Male Slip Luer (MSL)

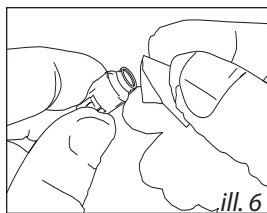

ill. 6

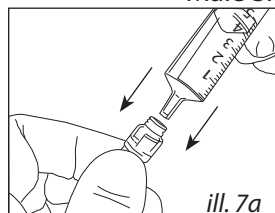

ill. 7a

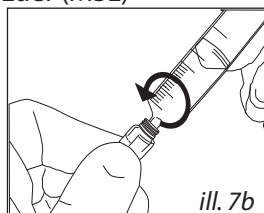

ill. 7b

Male Luer Lock (MLL)

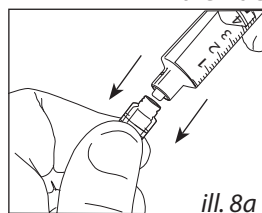

ill. 8a

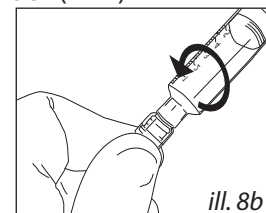

ill. 8b

- Twist counterclockwise to disconnect. The swabable valve completely closes after each use and therefore does not require a separate injection site cap.
- Flush the swabable valve device after each use per facility protocol.
- Change swabable device per facility protocol.
- Dispose of used device per facility protocol for biocontaminated materials.

All HR® Medical Components are shipped bulk, non-sterile and are single patient use medical device components requiring further processing (e.g. assembly, packaging, sterilization) before clinical use. The buyer is responsible for determining effects of processing/multiple usage on these components, appropriateness of the component in the final application, and pre/post shelf life.

US Patents 6,089,541~ 6,651,956 and foreign patents issued and pending
Made in the USA

Halkey-Roberts®
2700 Halkey-Roberts Pl. N.
St. Petersburg, FL 33716 USA
727.471.4200
www.halkeyroberts.com
sales@halkeyroberts.com